

LUSTER

Luster series installation instructions

1.

Model No	Cut-out	Model No	Cut-out
DR01201	Ø60mm	DR01202	Ø60mm
DR01203	Ø60mm	DR01204	Ø60mm
DR01205	Ø75mm	DR01206	Ø75mm
DR01207	Ø75mm	DR01208	Ø75mm
DR01209	Ø75mm	DR01210	Ø75mm
DR01211	Ø75mm	DR01212	Ø75mm
DR01213	Ø60mm	DR01214	Ø60mm
DR01215	Ø60mm	DR01216	Ø60mm
DR01217	Ø75mm	DR01218	Ø75mm
DR01219	Ø75mm	DR01220	Ø75mm

1. Installation Instructions (downlight with spring clips)

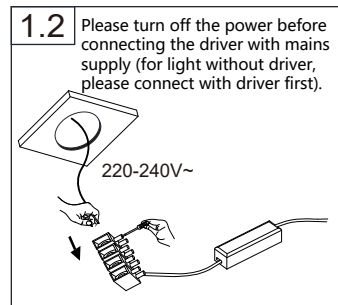
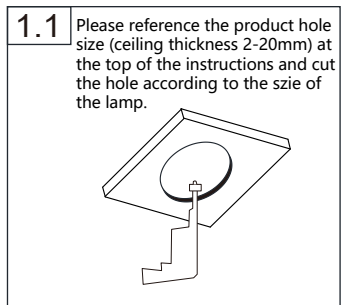

2.

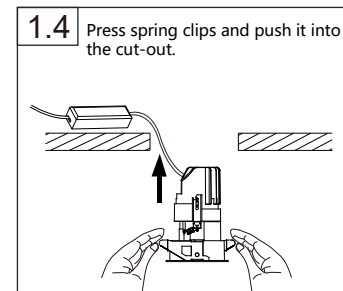
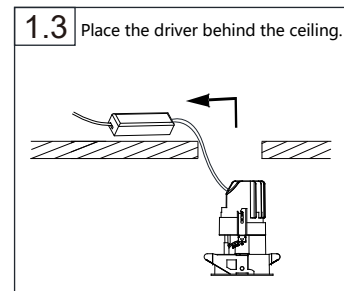

2. Installation Instructions (downlight with installation frame)

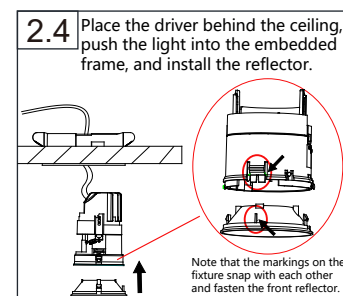
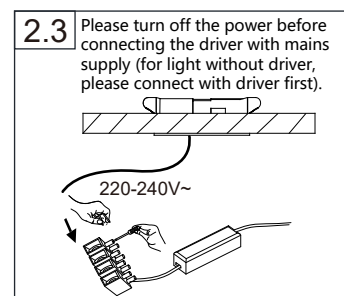
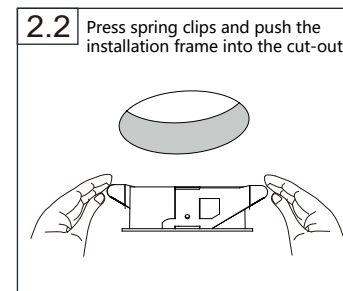
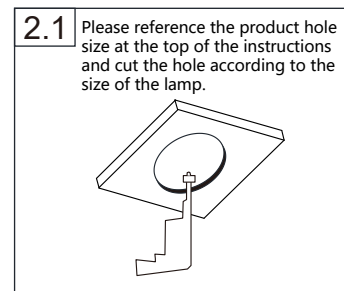

3.

3. Installation Instructions (trimless downlight)

Embedded part need to installed before the ceiling is plastered

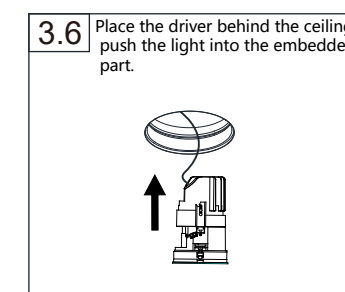
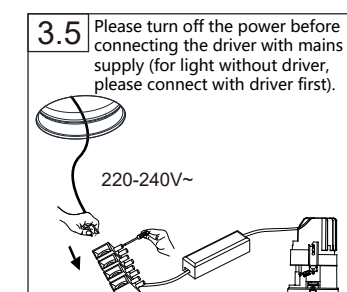
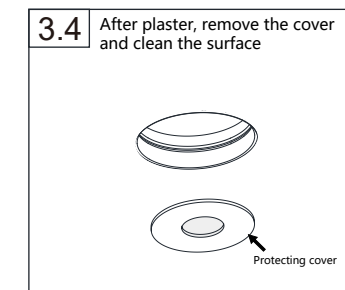
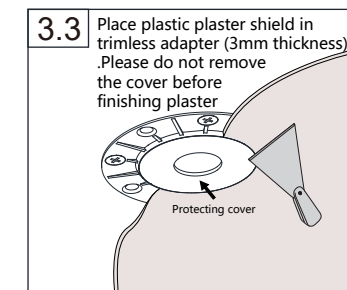
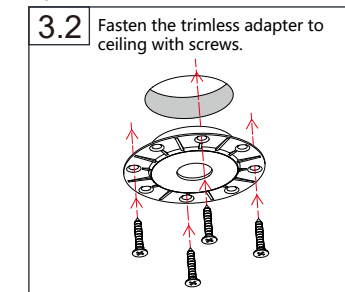
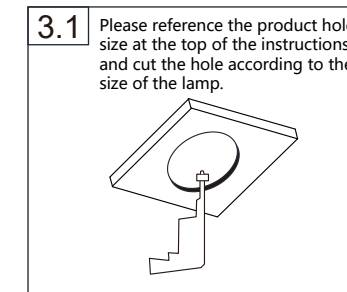

4.

4. Lamp maintenance instructions

This instruction is applicable to both trim and trimless downlight

4.1 Turn off the power, remove the front reflector, pull the lamp down

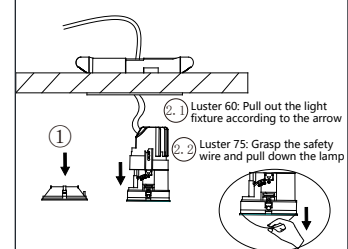

4.2 Pull out the buckles on both sides to separate the lamp

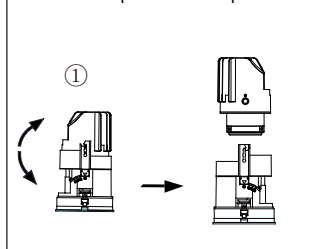

4.3 Replace the original accessory with new one

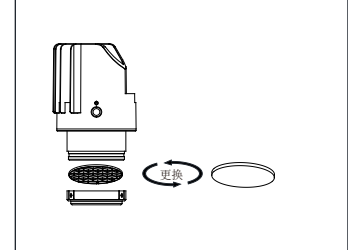

4.4 Reassemble the lamp

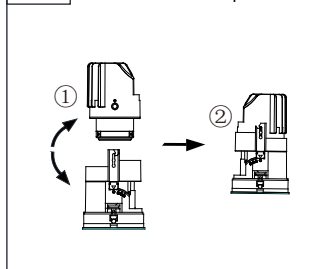

4.5 Push the light into the embedded part, then fasten the reflector

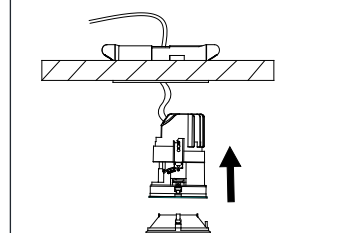

4.6 Installation completed

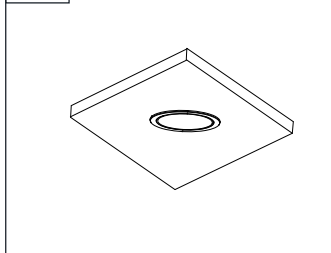

5. MR16 lamp maintenance instructions

Note: Please do not use halogen light source

5.1 Pull up the spring

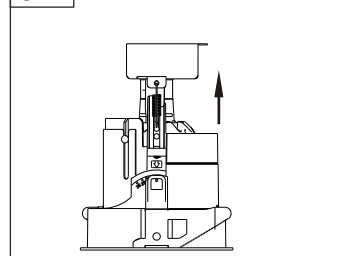

5.2 Tilt to take out the MR16 light bulb and replace it

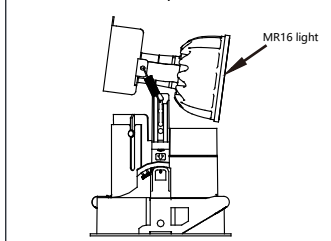

5.3 If honeycomb or soft lens need to be changed, please reference step 5.1-5.2

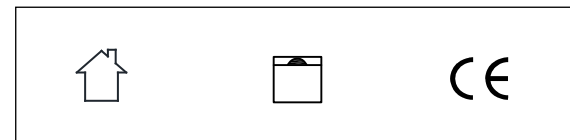
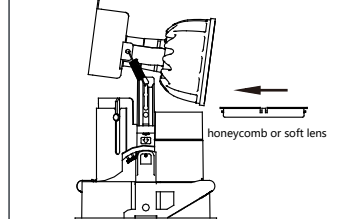

This product is only suitable for indoor, it is not allowed to be rinsed with water.



Independent external driver, recessed mounted.

Do not clean LED chip and reflector with hand or towel !



- Use only drivers that comply with IEC or CE safety standards.
- Check if the power supply match with the luminaire.
- Must consider the maximum current value displayed on the label of the luminaire.
- The voltage displayed on the luminaire is not used to select the constant voltage driver, but the voltage covered by the selected constant current driver.
- Take suitable ESD measures to avoid touching bare conductors.
- LED chips can be damaged if be in touch with chemical material or gas. Therefore, it is not allowed to clean the LED housing or luminaire by chemicals.
- The following items are confirmed to have negative impact on the performance of the luminaire, avoid to keep luminaire in the same circumstance with them.
 - Methyl acetate or ethyl acetate (i.e., nail polish remover)
 - Cyanoacrylates (i.e., "Superglue")
 - Glycol ethers (including Radio Shack ® Precision Electronics Cleaner - dipropylene glycol monomethyl ether)
 - Formaldehyde or butadiene (including Ashland PLIOBOND ® adhesive)
 - Dymax 984-LVUF conformal coating
 - Loctite Sumo Glue, Loctite 384 adhesive, Loctite 7387 activator
 - Gorilla Glue, Bleach, Bleach-containing cleaners, sprays

- Remove the insulation material from the luminaire or provide enough space so that the temperature raising will not overpass the limited TC.
- LED chip is very sensitive to switching transients, therefore, LED lamps and appliances must be connected after power cut off, no hotswappable.
- Recommends using the driver indicated on the luminaire manual.
- Must consider the polarity of the product.
- It is recommended to use an ambient temperature of -10 ° C to 40 ° C for indoor lighting equipment
- If the external flexible cable or cord of this lamp is damaged, the cord should be replaced by the manufacturer or its service agent or a similarly qualified person
- The light source in this lamp should be replaced by the manufacturer or its service agent or a similarly qualified person

5.

6.

7.

8.